

G2

Installation Manual

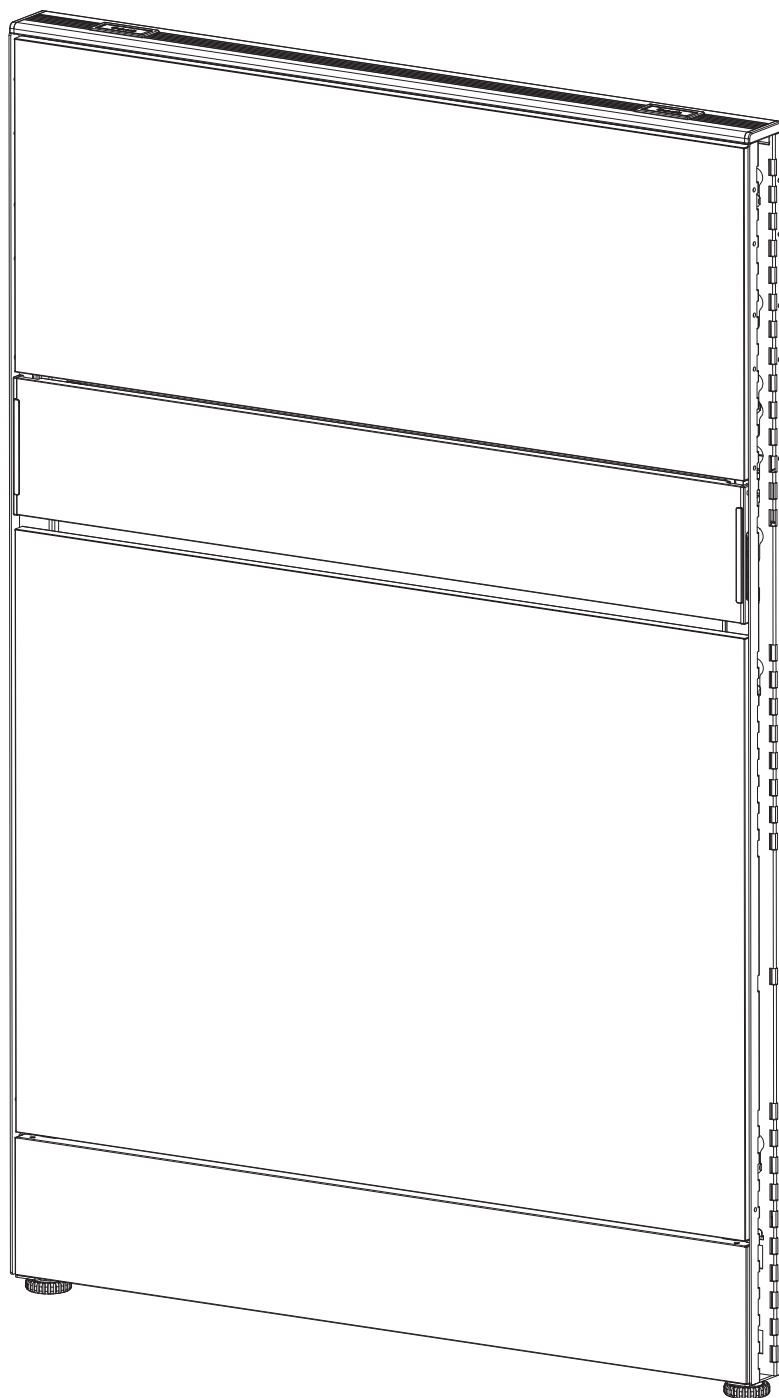

Genesis

INDEX

1. Recommended Tools

2. Connecting Frame to Frame

3. Connecting the Frame to the Connector

4. Connecting the Base Cover

5. Connecting the Tile

6. Connecting Top Cover and End Cover

7. Connecting the Safety Angle

8. Connecting the Stackable Frame

9. Connecting the shelf

1. Recommended Tools

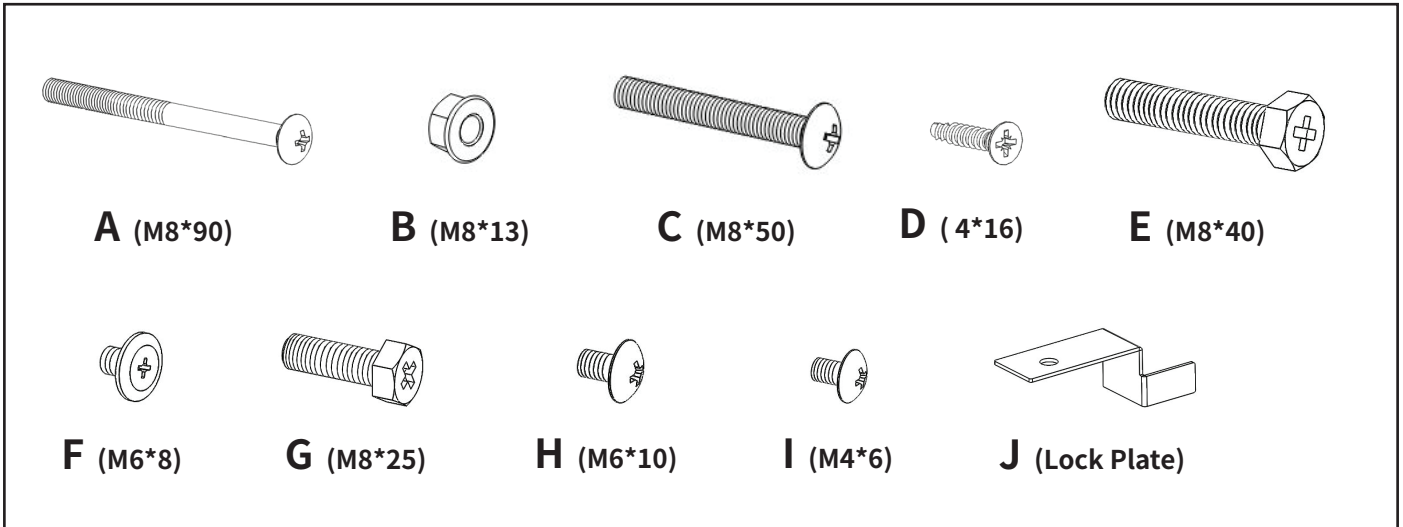

2. Connecting Frame to Frame

Step 1

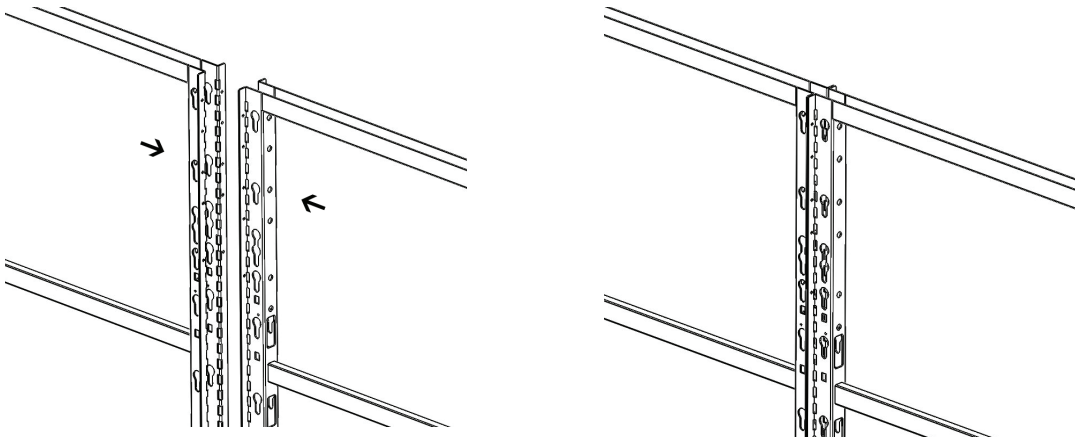

Step 2

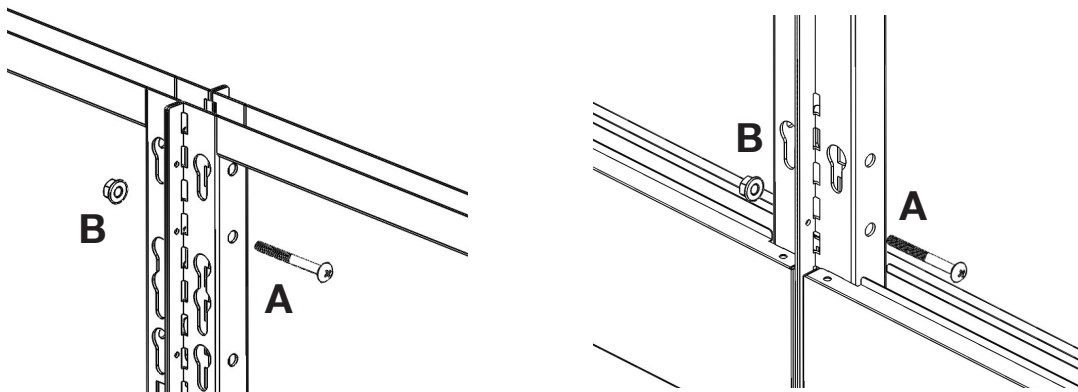

3. Connecting the Frame to the Connector

Step 1

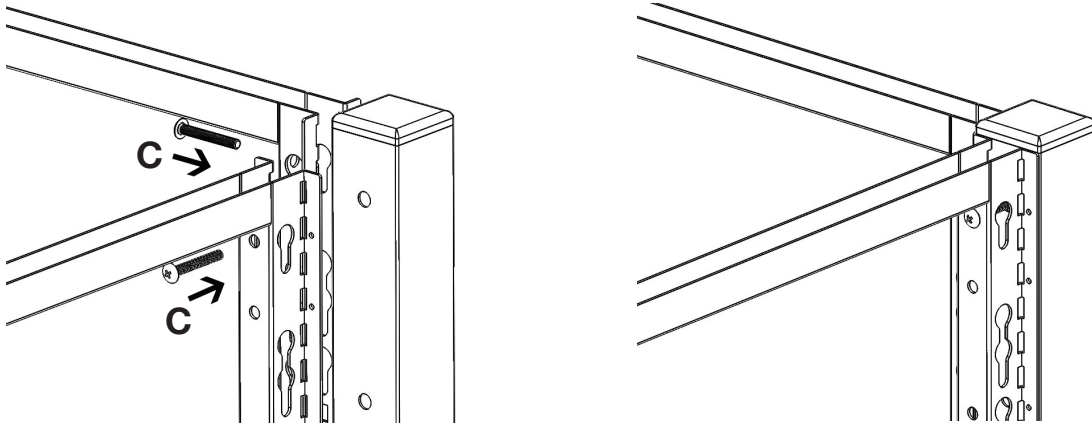

Step 2

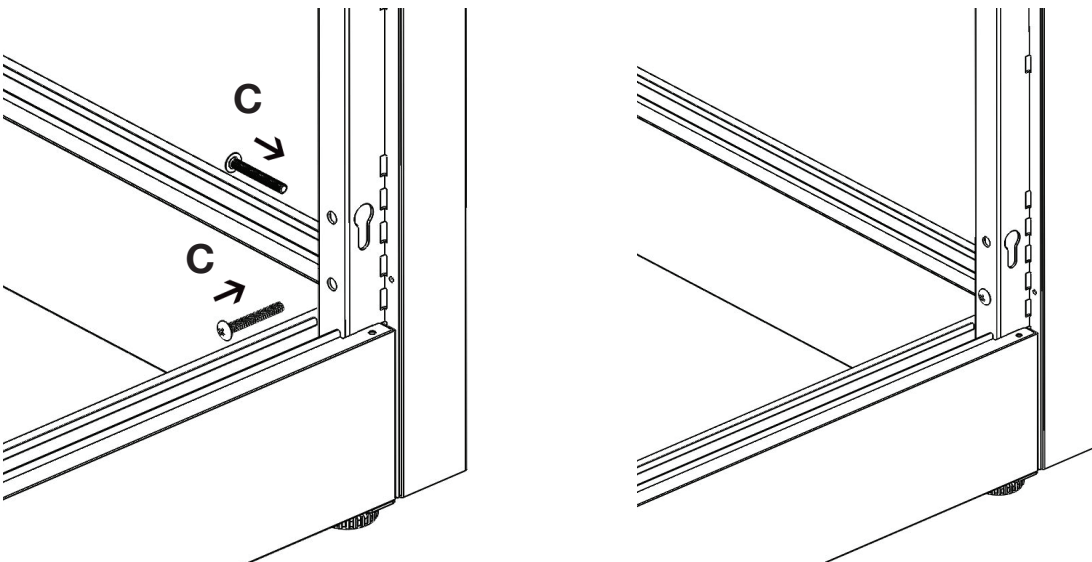

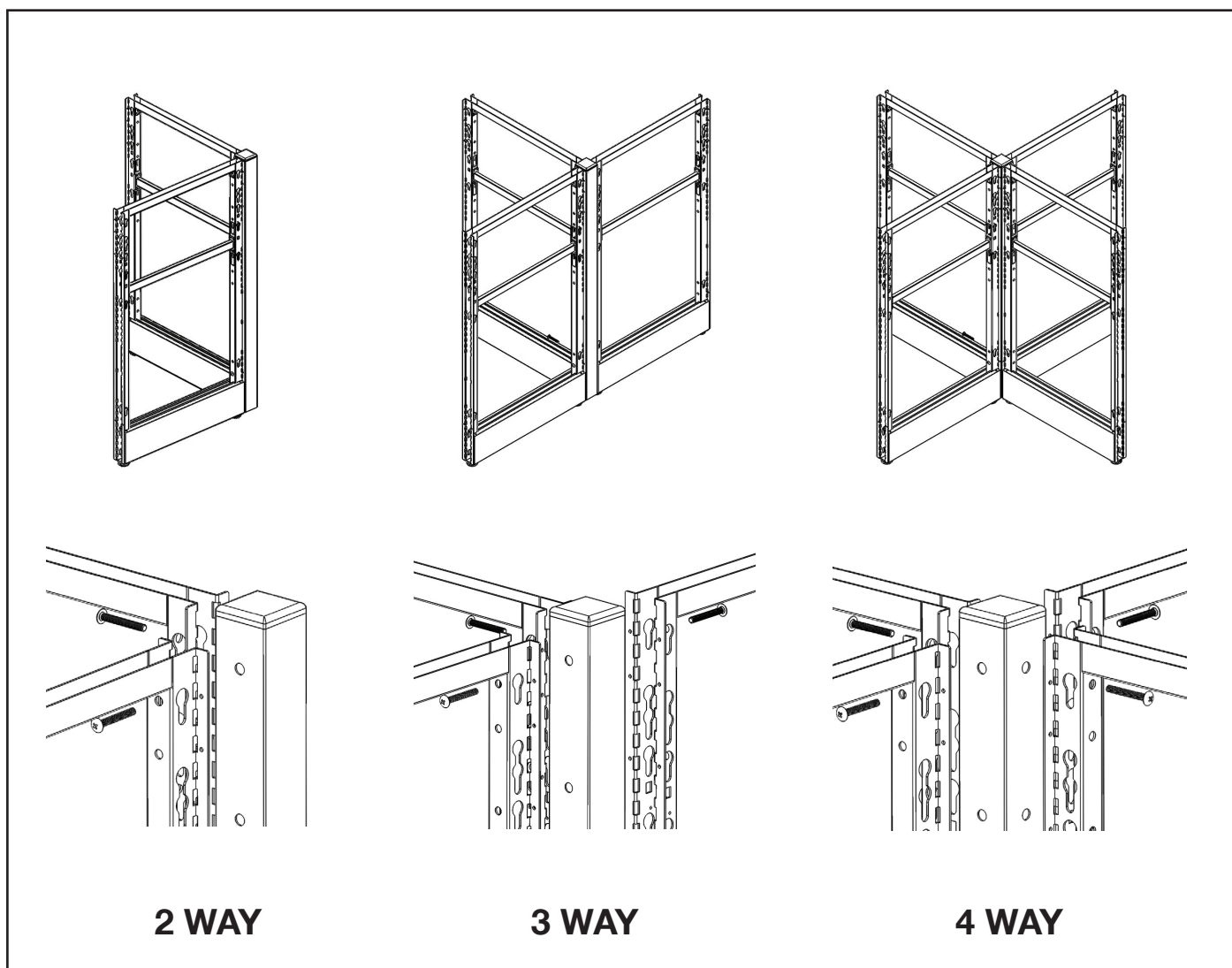

4. Connecting the Base Cover

Step 1

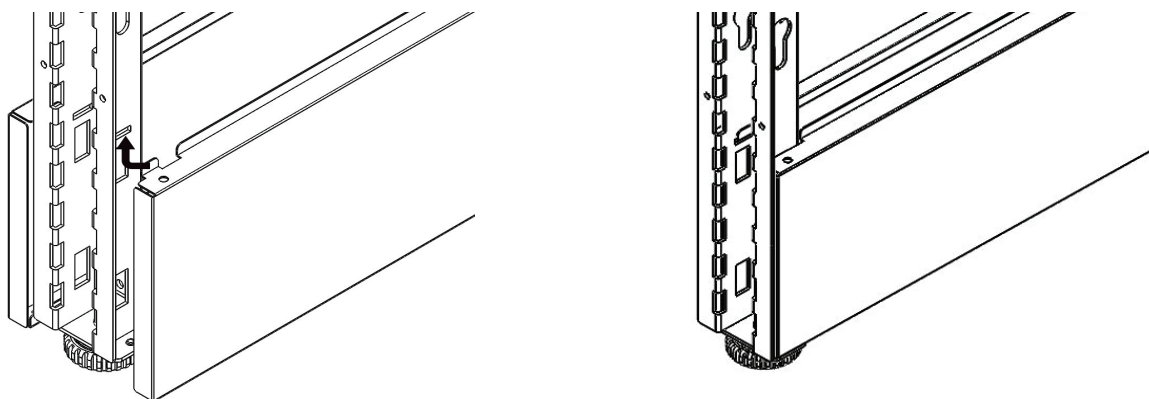

5. Connecting the Tile

Step 1

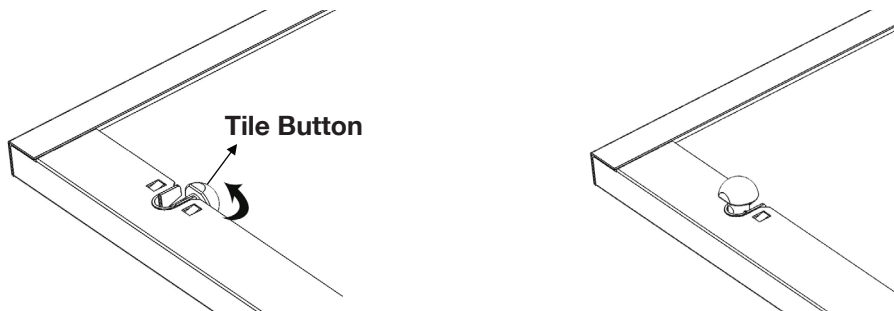

Step 2

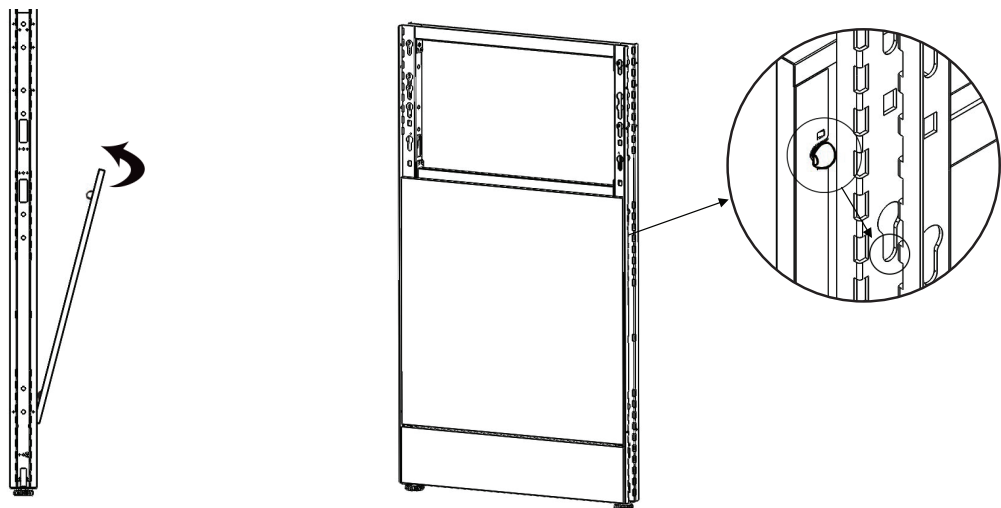

Step 1

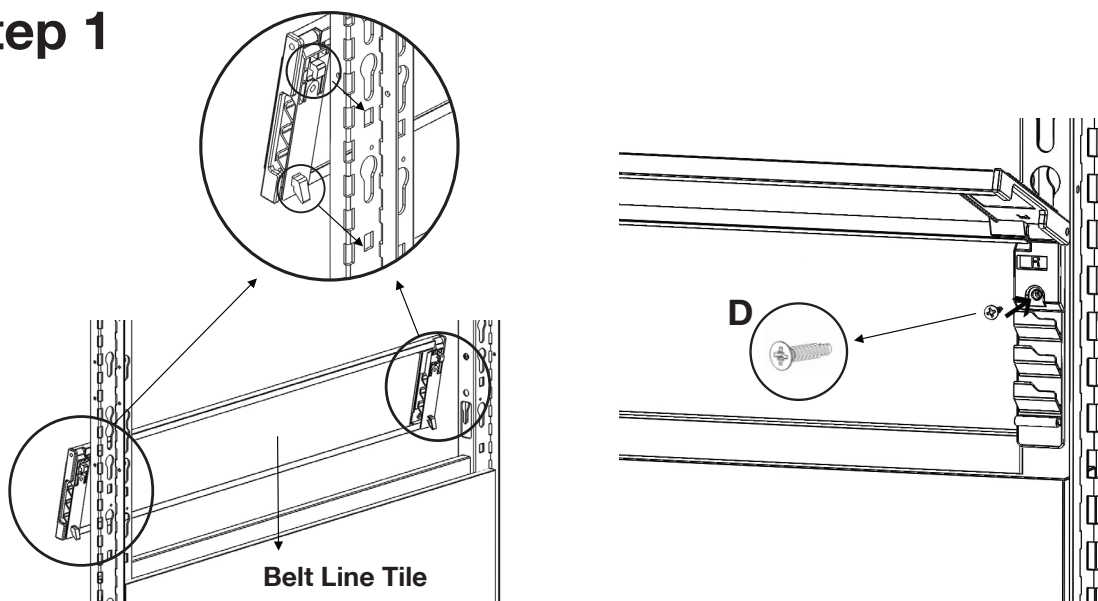

6. Connecting Top Cover and End Cover

Step 1

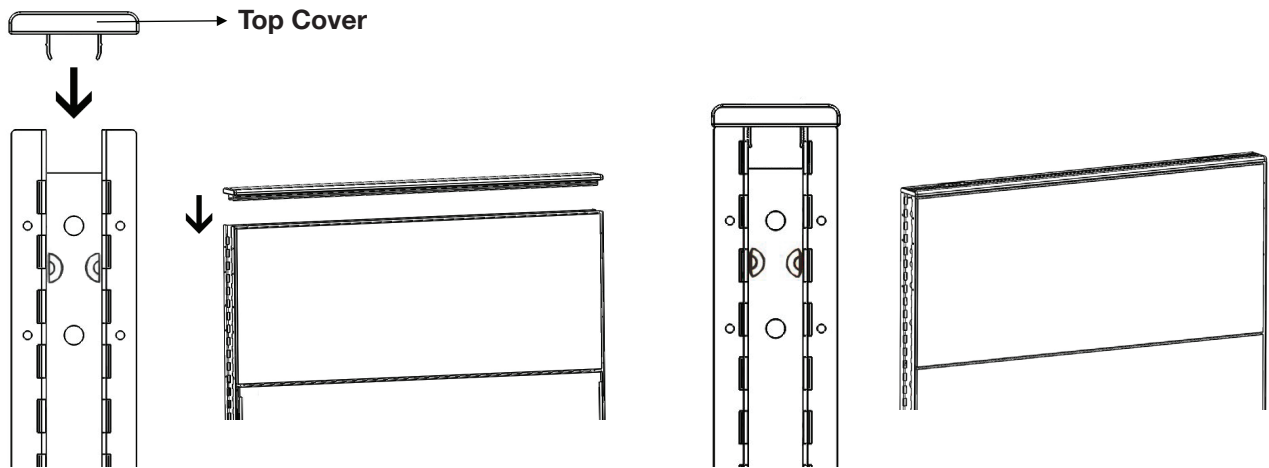

Step 1

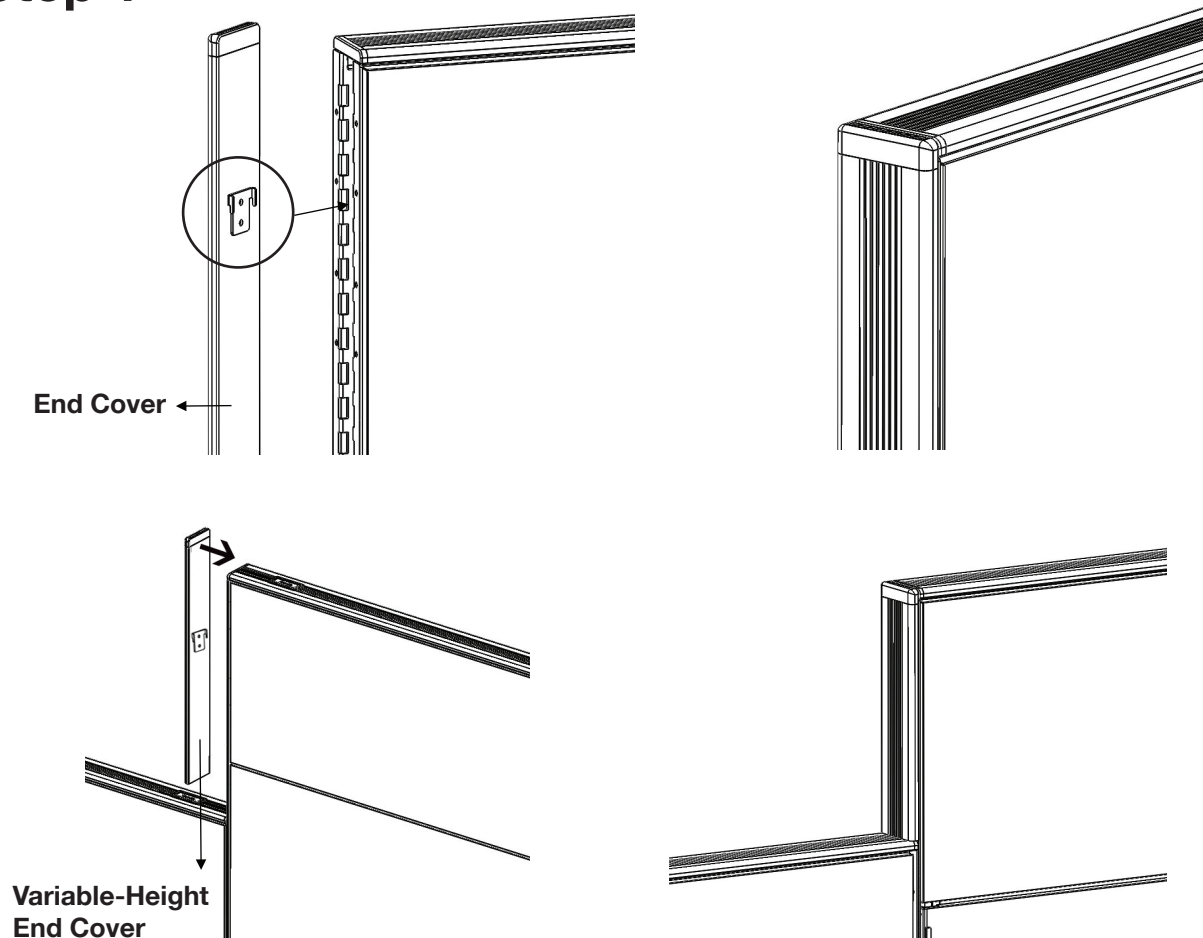

7. Connecting the Safety Angle

Step 1

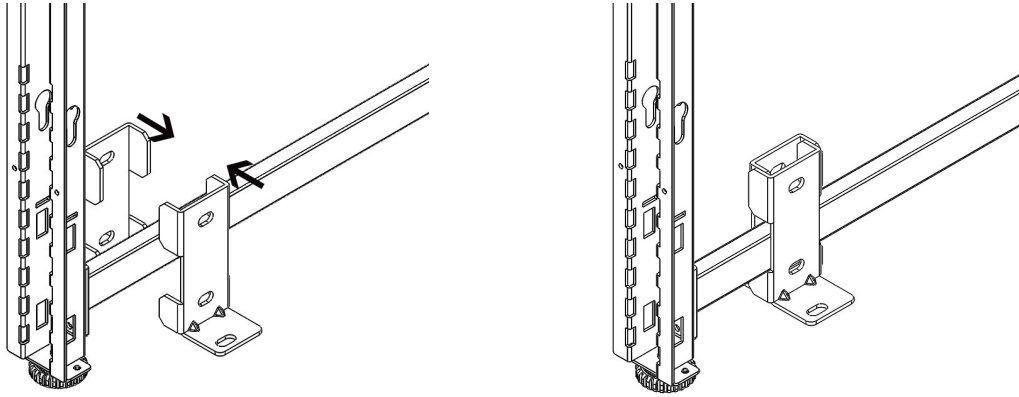

Step 2

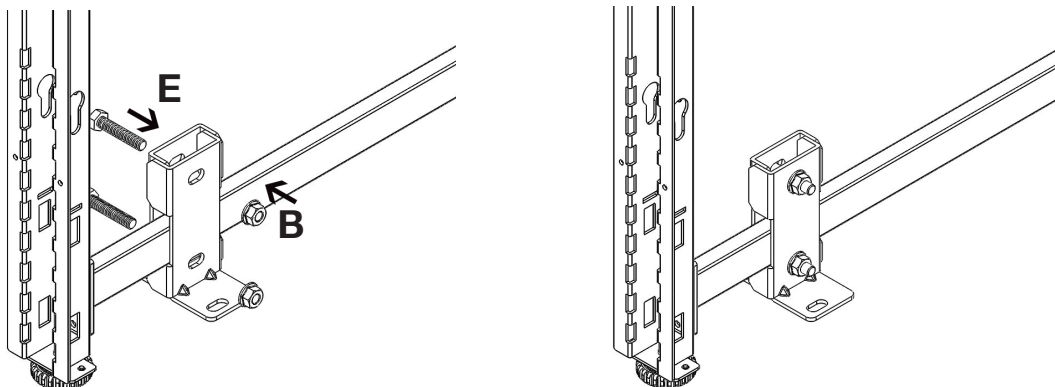

Step 3

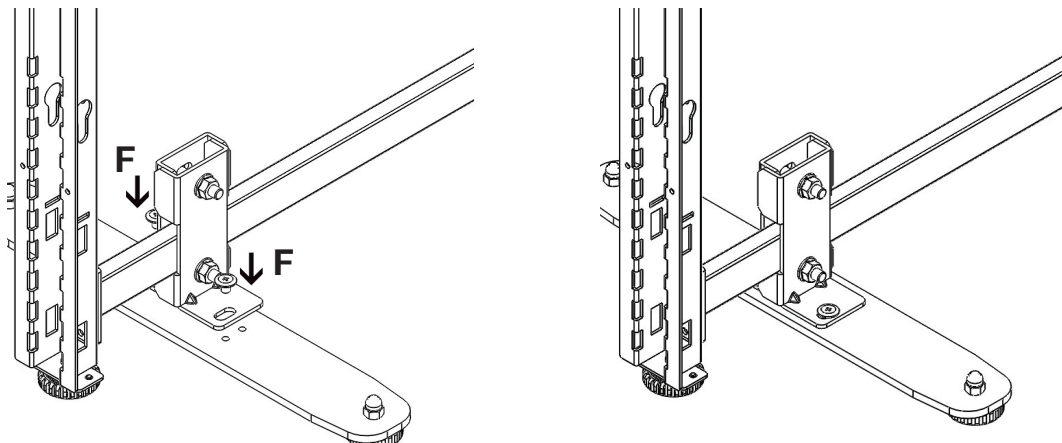

8. Connecting the Stackable Frame

Step 1

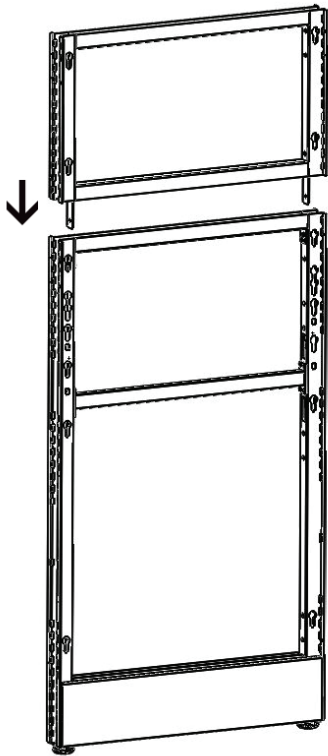

Step 2

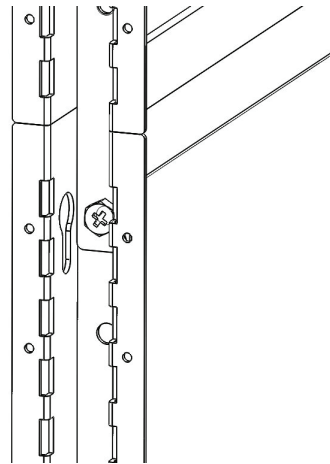
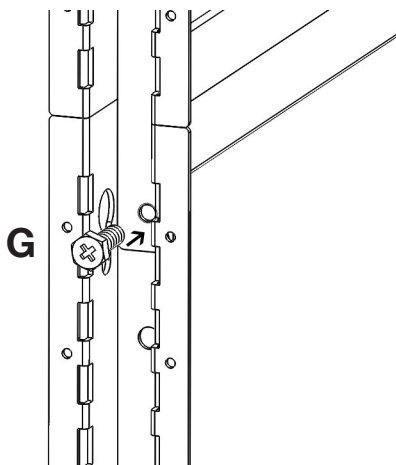

9. Connecting the shelf

Step 1(Overhead Bin)

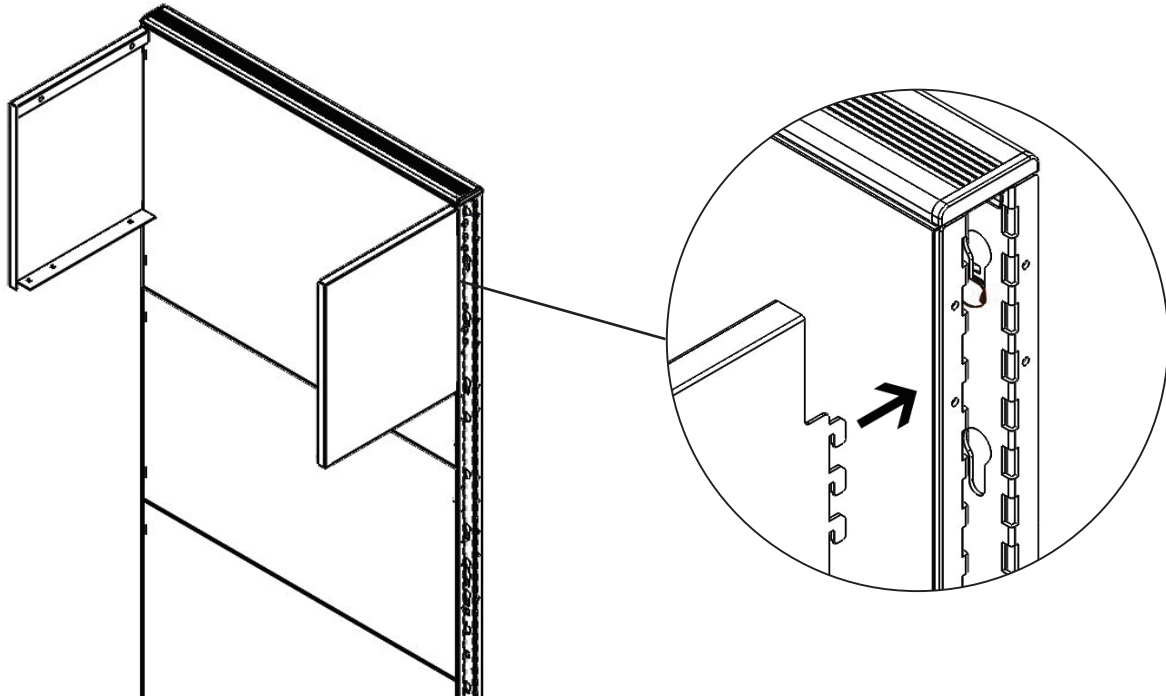

Step 2

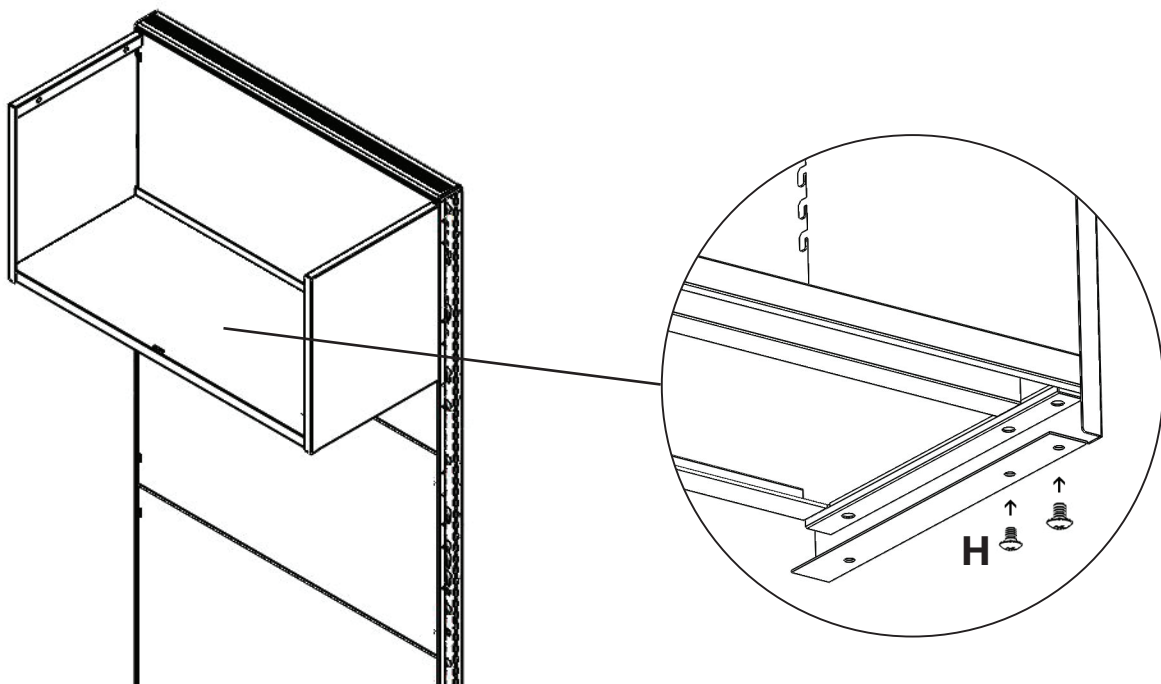

Step 3

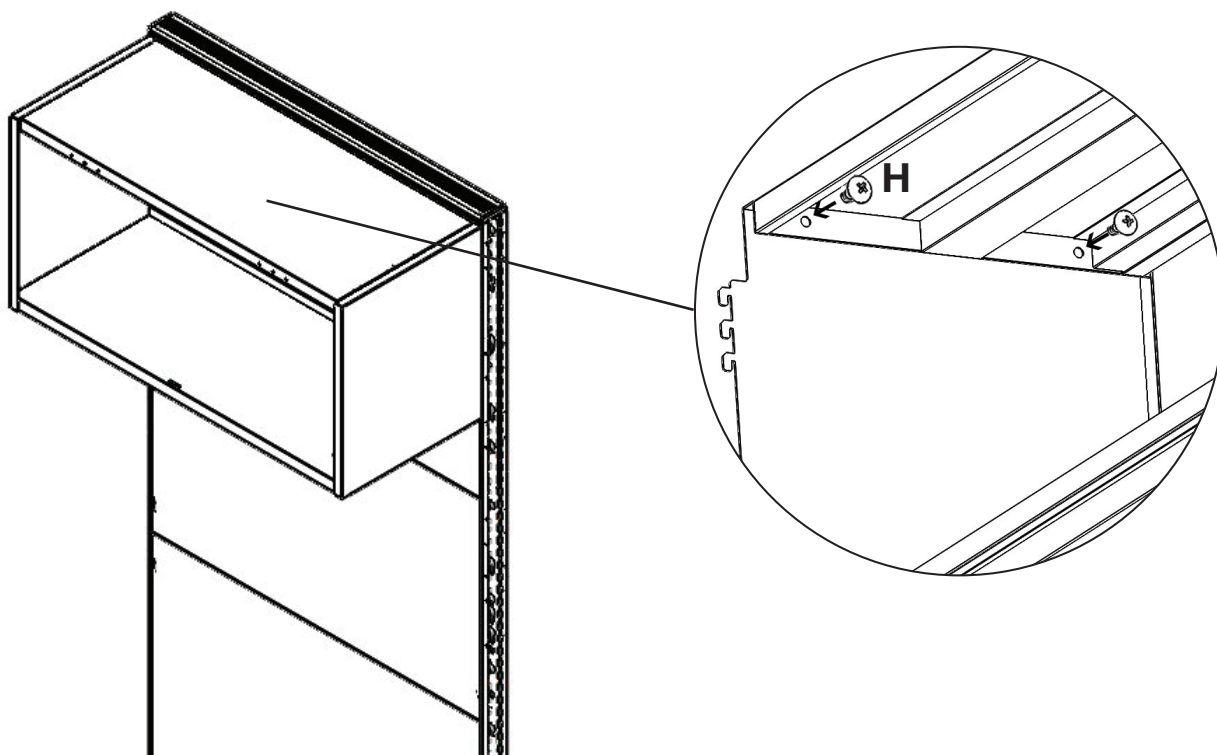

Step 4

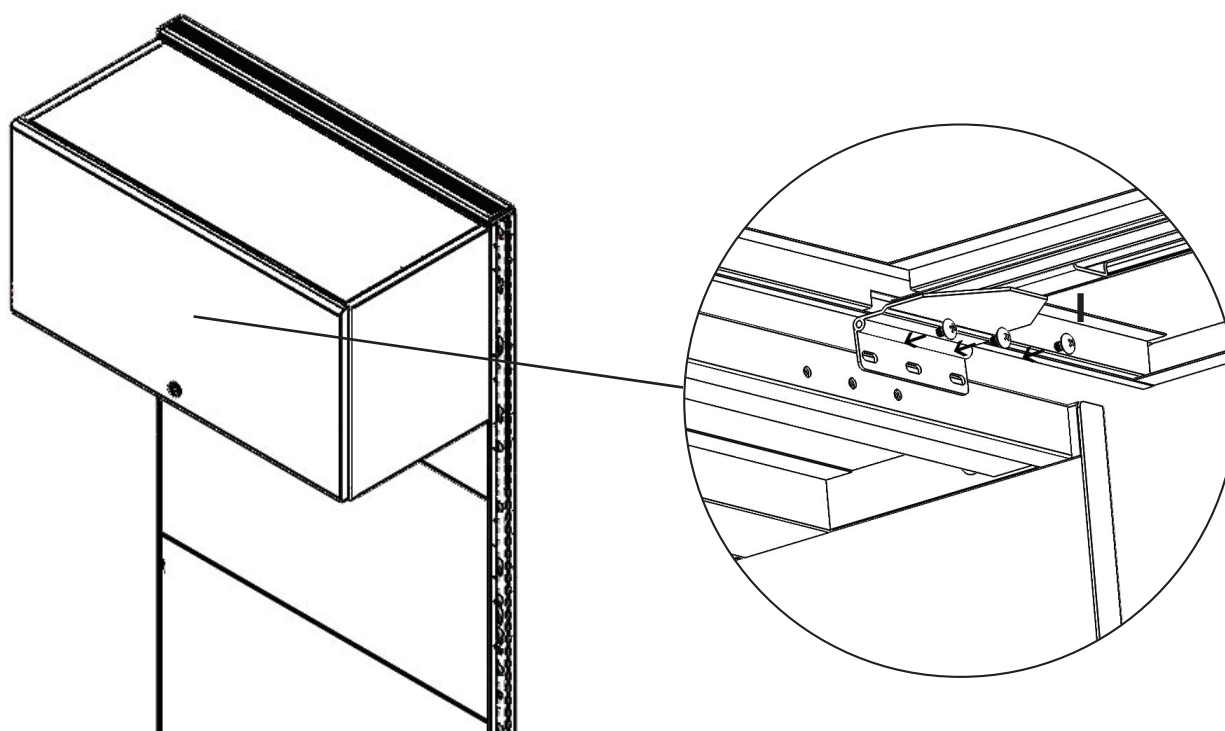

Step 5

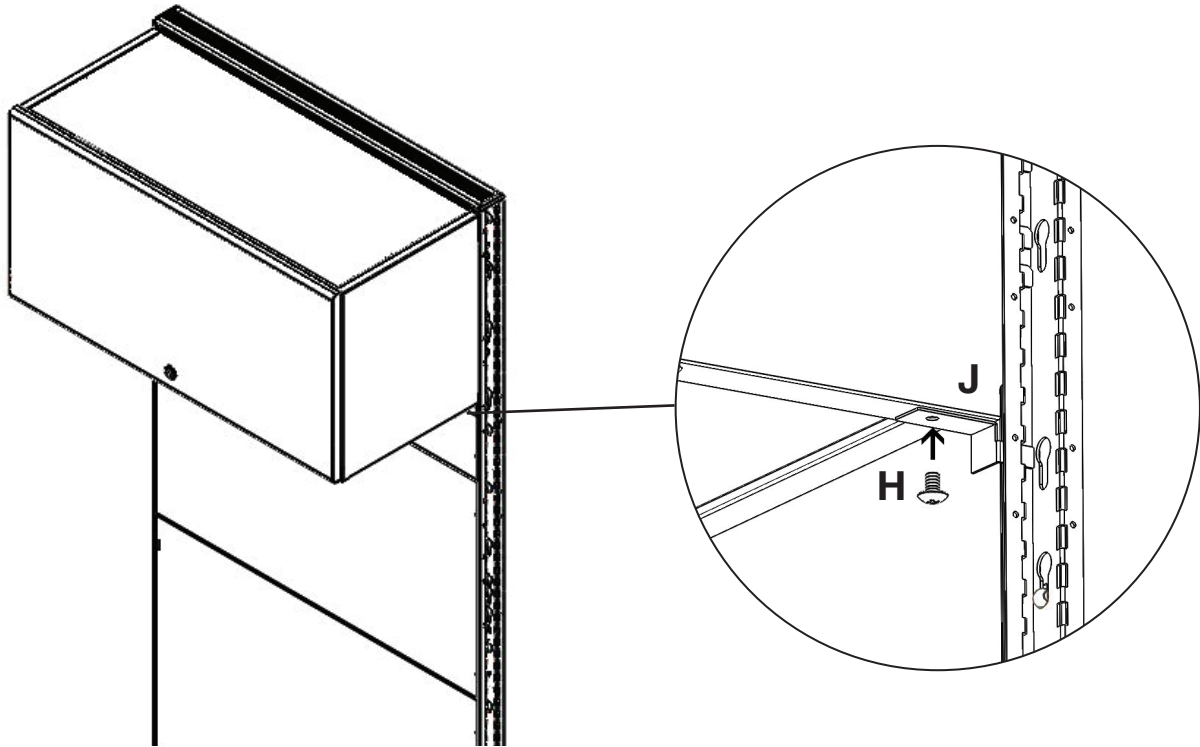

Step 1 (Open shelf)

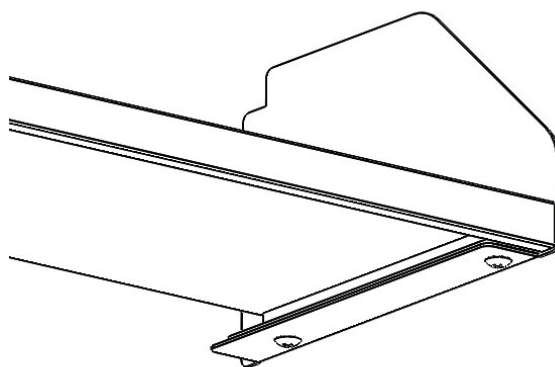
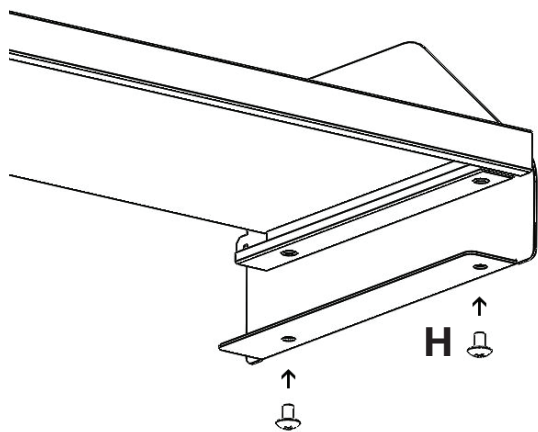

Step 2

